

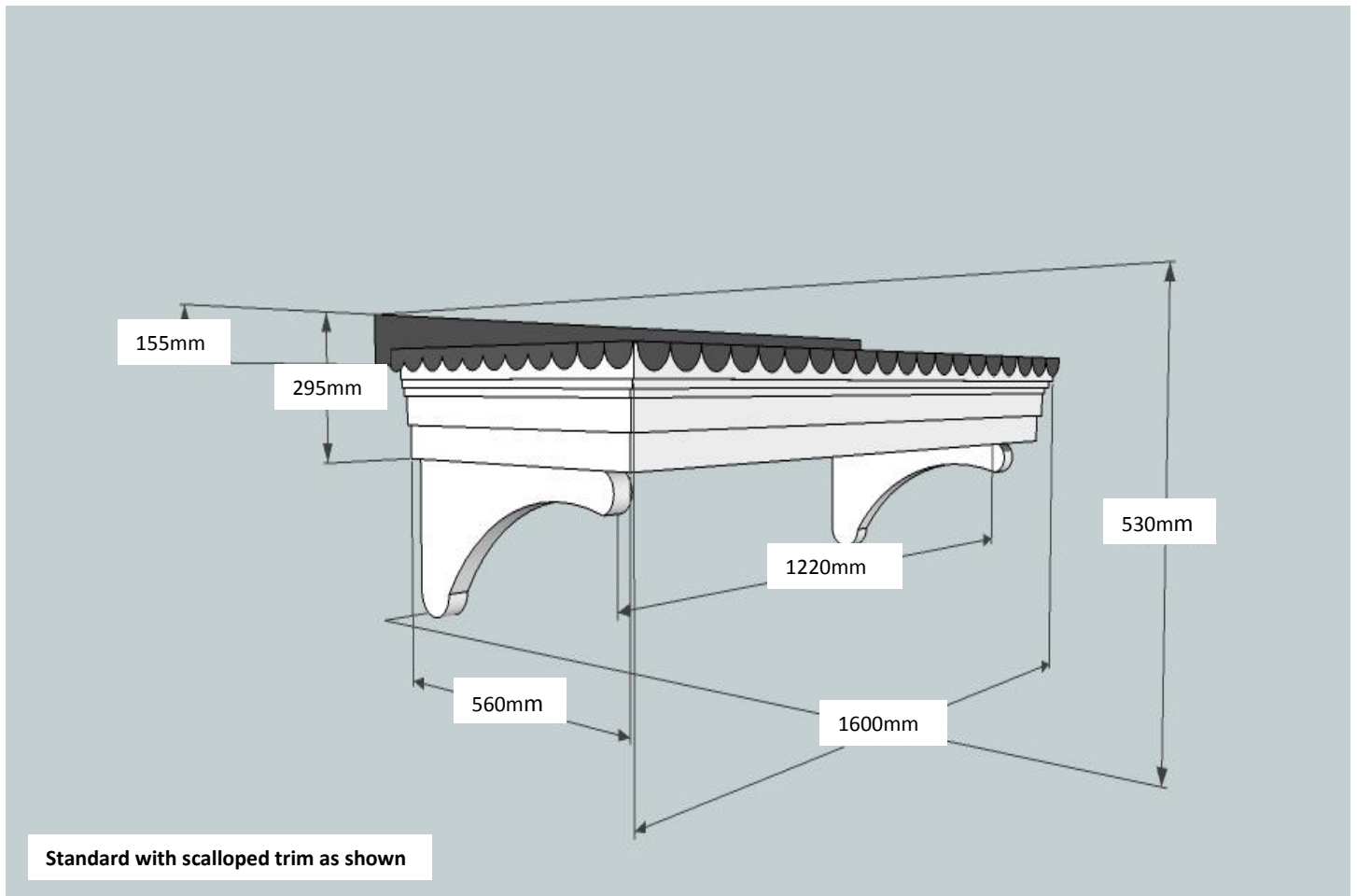

Standard Royale Door Canopy



'V' shaped (galvanised) fixing brackets are supplied with canopies to aid installation.

Fix the brackets to the wall with M8 bolts ensuring they are level. Place the canopy onto the brackets and secure the canopy by hammer fixings through the flashing

Seal the flashing and sides of the canopy with silicone, clear at the top and white at the sides

CLEANING/AFTER CARE

All our canopies are maintenance free, they will never require painting. However, to maintain their good looks, periodic cleaning is advisable. Use warm water and detergent removing any persistent stains with a bristle brush. Clean off any tar or grease deposits with White spirit.



Extended Royale Canopy

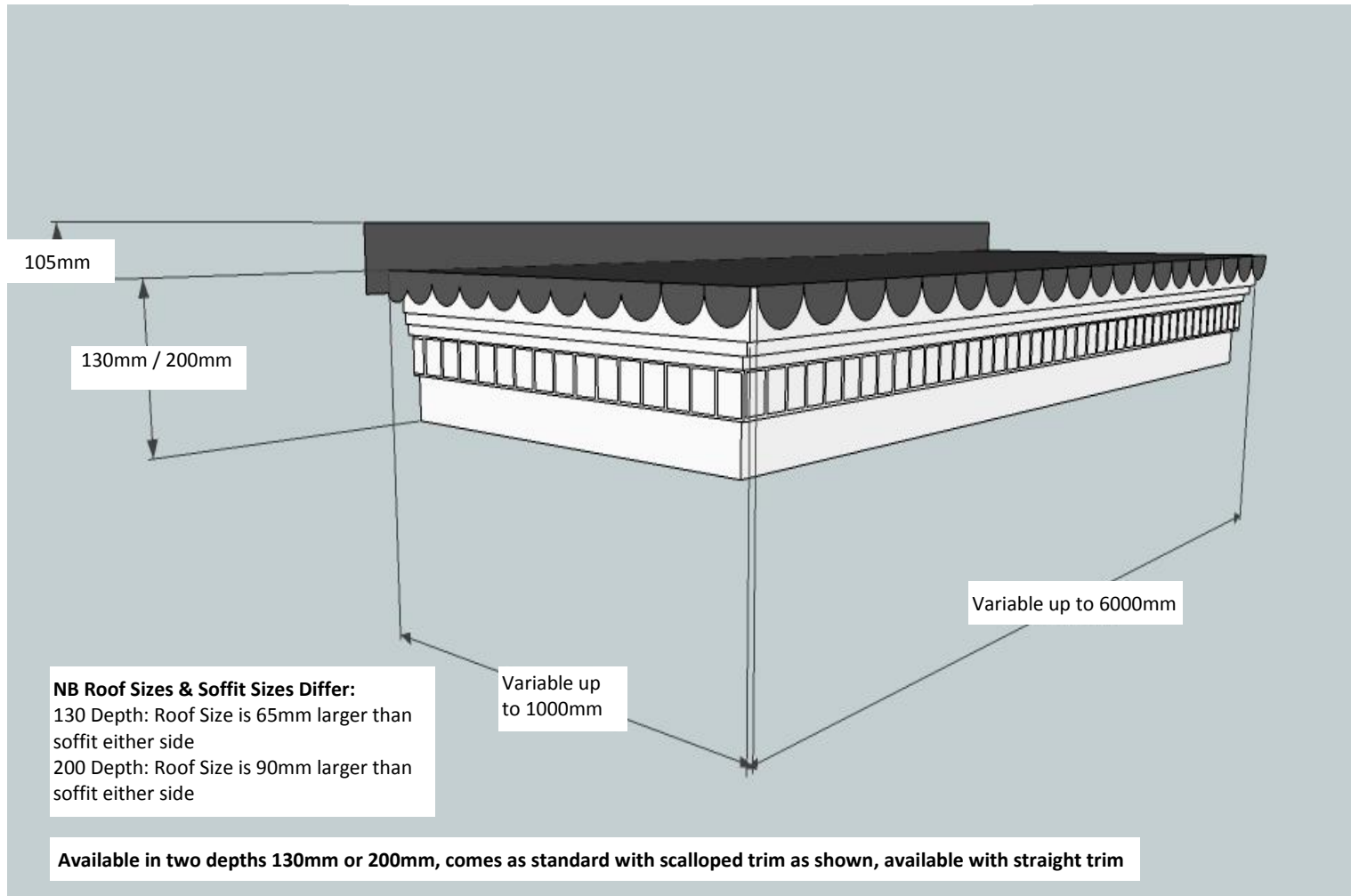

'V' shaped (galvanised) fixing brackets are supplied with canopies to aid installation.

Fix the brackets to the wall with M8 bolts ensuring they are level. Place the canopy onto these brackets. Secure the canopy by hammer fixings through the top flashing..

Seal the flashing and the sides of the canopy with silicone, clear at the top and white at the sides.

CLEANING/AFTER CARE

All our canopies are maintenance free, they will never require painting. However, to maintain their good looks, periodic cleaning is advisable. Use warm water and detergent removing any persistent stains with a bristle brush. Clean off any tar or grease deposits with White spirit.



Princess Door Canopy

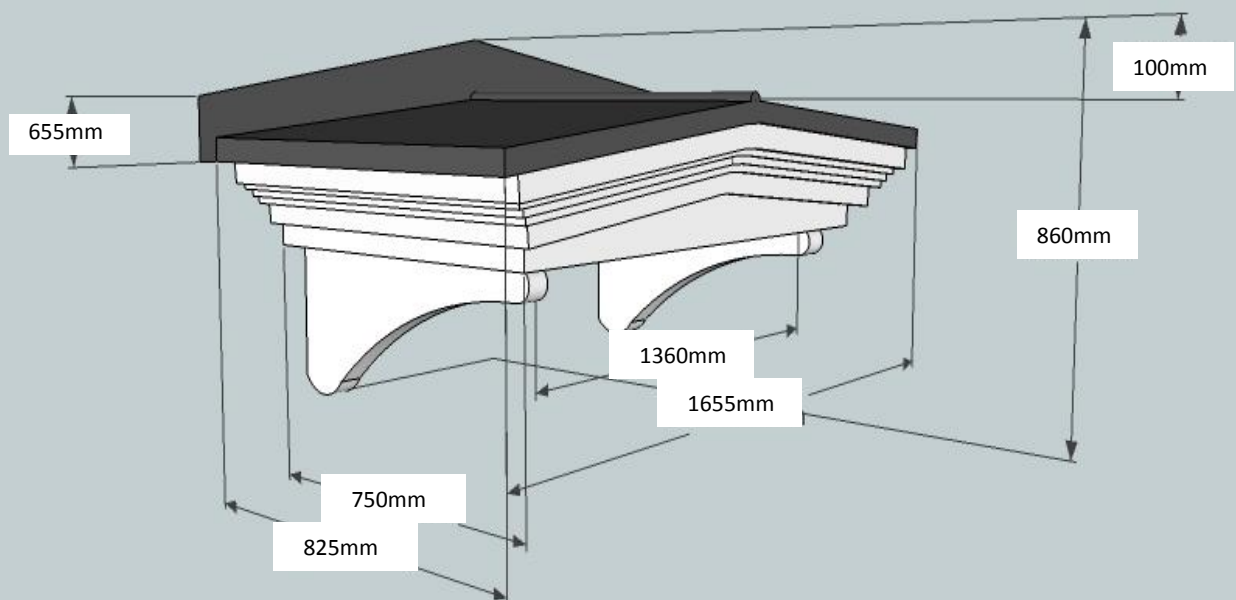

Available with décor legs included as one piece, or without – décor legs can be ordered separately

An "L" Shaped galvanised fixing bracket is supplied to aid installation

Bracket is bolted to the wall using M8 Rawl Bolt where the centre of the canopy is located, approximately 420mm above the door casing.

The canopy is then pushed onto the fixing bracket and fixed through the fixing points on the flashing (visible dimples). Fix down the sides and bottom flanges, seal at the top and sides with silicone sealant, use clear for the top and white for the sides. Do not seal the soffit to the wall

Fixing: 60mm x 8mm hammer fixings (approx 16 per canopy)

CLEANING/AFTER CARE

All our canopies are maintenance free, they will never require painting. However, to maintain their good looks, periodic cleaning is advisable. Use warm water and detergent removing any persistent stains with a bristle brush. Clean off any tar or grease deposits with White spirit.



Extended Princess Door Canopy

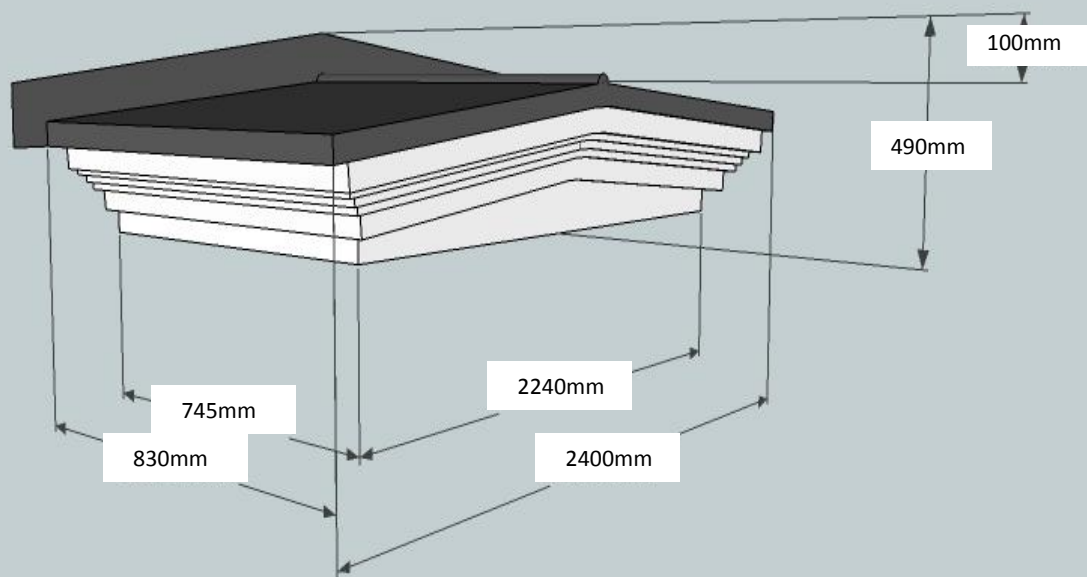

Available as shown, or with décor legs included as one piece (distance between legs: 2000mm), décor legs can be ordered separately

An 'L' shaped (galvanised) fixing bracket is supplied with canopies to aid installation where no legs are attached
Where legs are attached to "V" shaped brackets are supplied

"L" shaped bracket is fixed to the wall using M8 Rawl Bolt where the centre of the canopy is located and canopy is pushed onto the fixing bracket

"V" shaped brackets are fixed to the wall using M8 Bolts align with the slots in the canopy, canopy is then slotted onto brackets

Fix down the sides and bottom flanges, seal flashing at the top and sides with silicone sealant, use clear for the top, white for the sides. Do not seal the soffit to the wall.

CLEANING/AFTER CARE

All our canopies are maintenance free, they will never require painting. However, to maintain their good looks, periodic cleaning is advisable. Use warm water and detergent removing any persistent stains with a bristle brush. Clean off any tar or grease deposits with White spirit.



Cottage Door Canopy

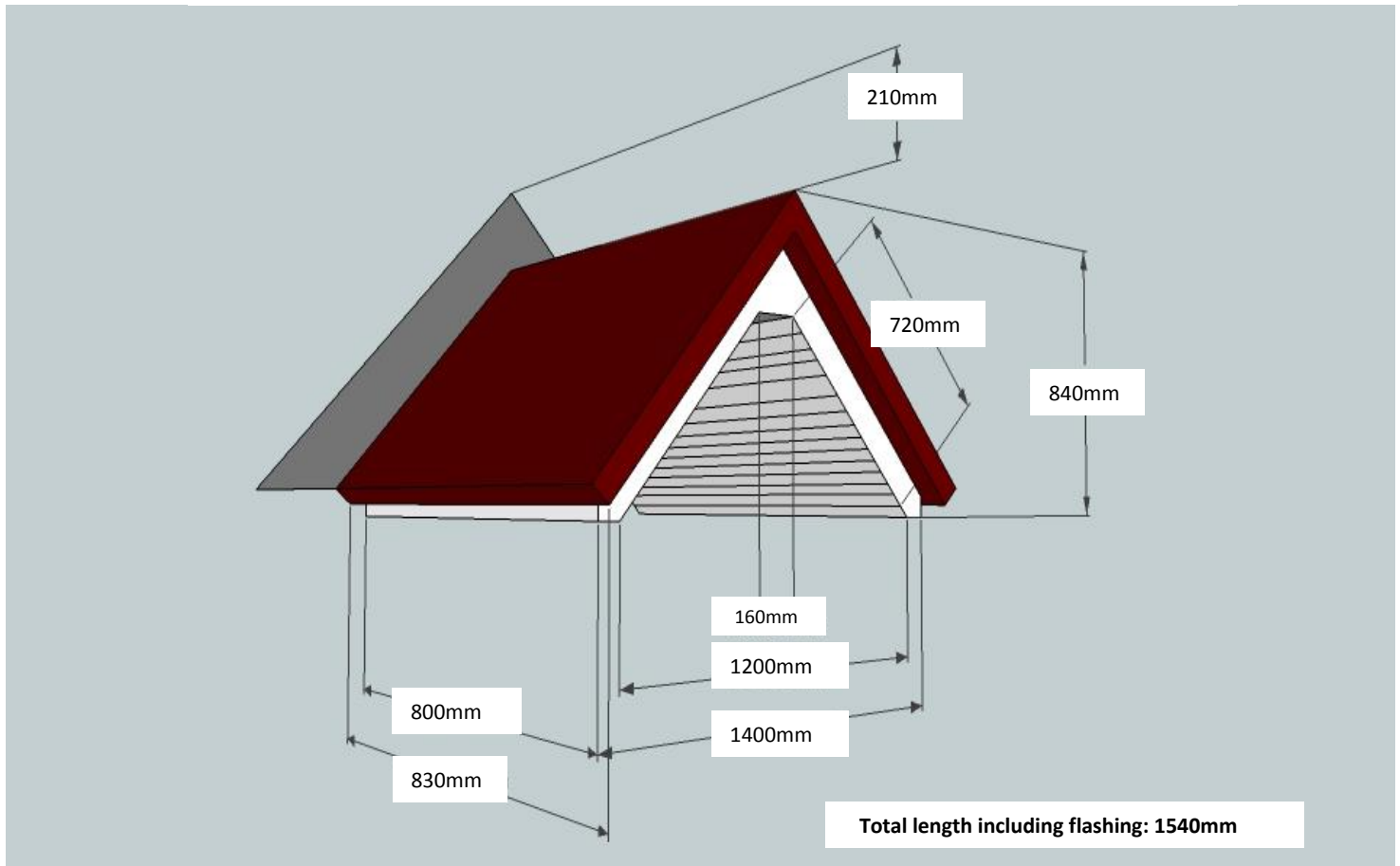

Fix the galvanised angle bracket (supplied) over the door using M8 Rawl Bolts (supplied), approximately 800mm over door casing. Lift and locate canopy on angle bracket. Level the canopy and fix using hammer fixings

Seal the flashing using clear silicone. Do not seal the soffit to the wall

CLEANING/AFTER CARE

All our canopies are maintenance free, they will never require painting. However, to maintain their good looks, periodic cleaning is advisable. Use warm water and detergent removing any persistent stains with a bristle brush. Clean off any tar or grease deposits with White spirit.



Kensington Door Canopy

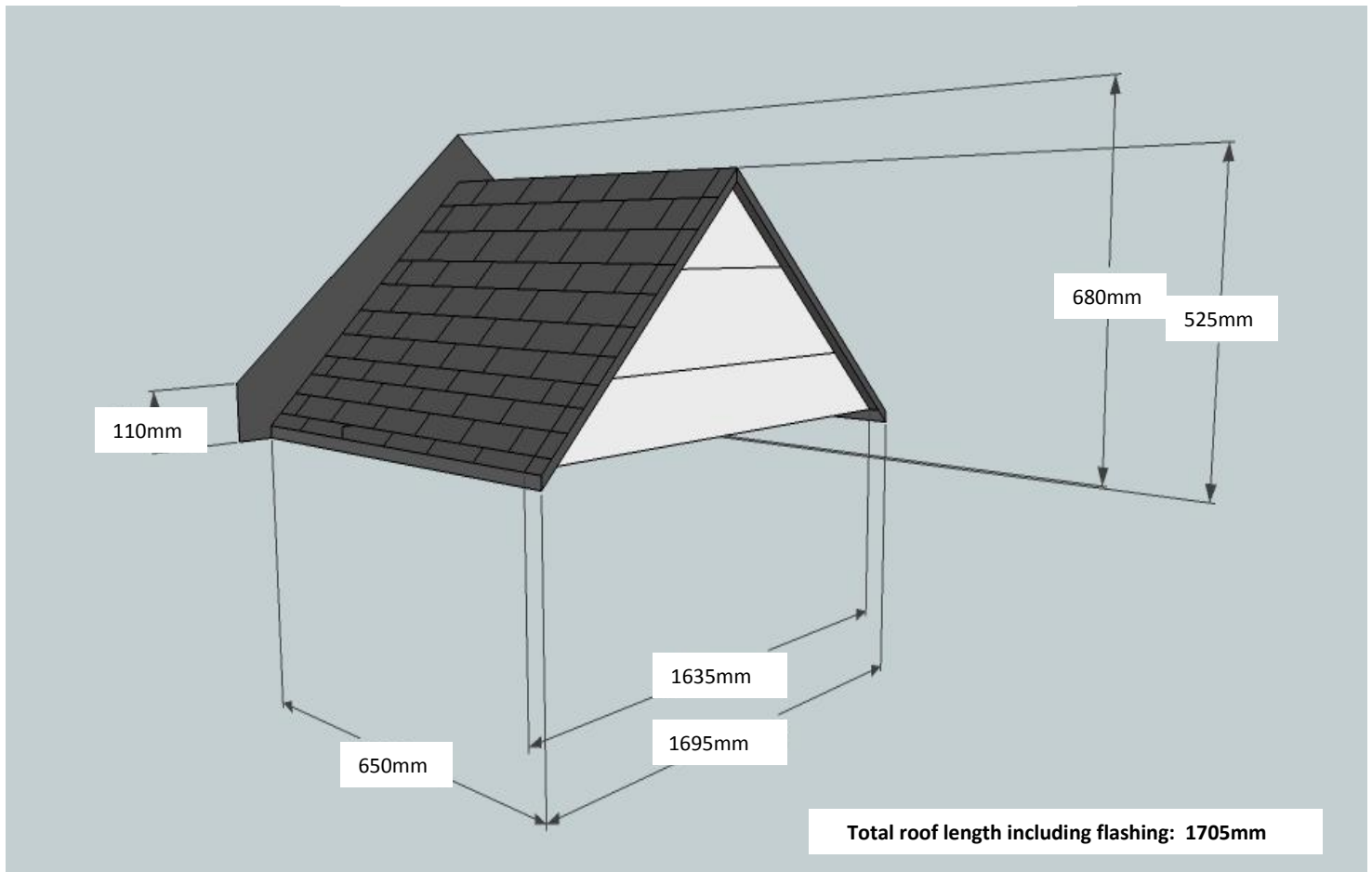

Fix the galvanised angle bracket (supplied) over the door using M8 Rawl Bolts (supplied), approximately 800mm over door casing. Lift and locate canopy on angle bracket. Level the canopy and fix using hammer fixings

Seal the flashing using clear silicone. Do not seal the soffit to the wall

CLEANING/AFTER CARE

All our canopies are maintenance free, they will never require painting. However, to maintain their good looks, periodic cleaning is advisable. Use warm water and detergent removing any persistent stains with a bristle brush. Clean off any tar or grease deposits with White spirit.



Tudor Door Canopy

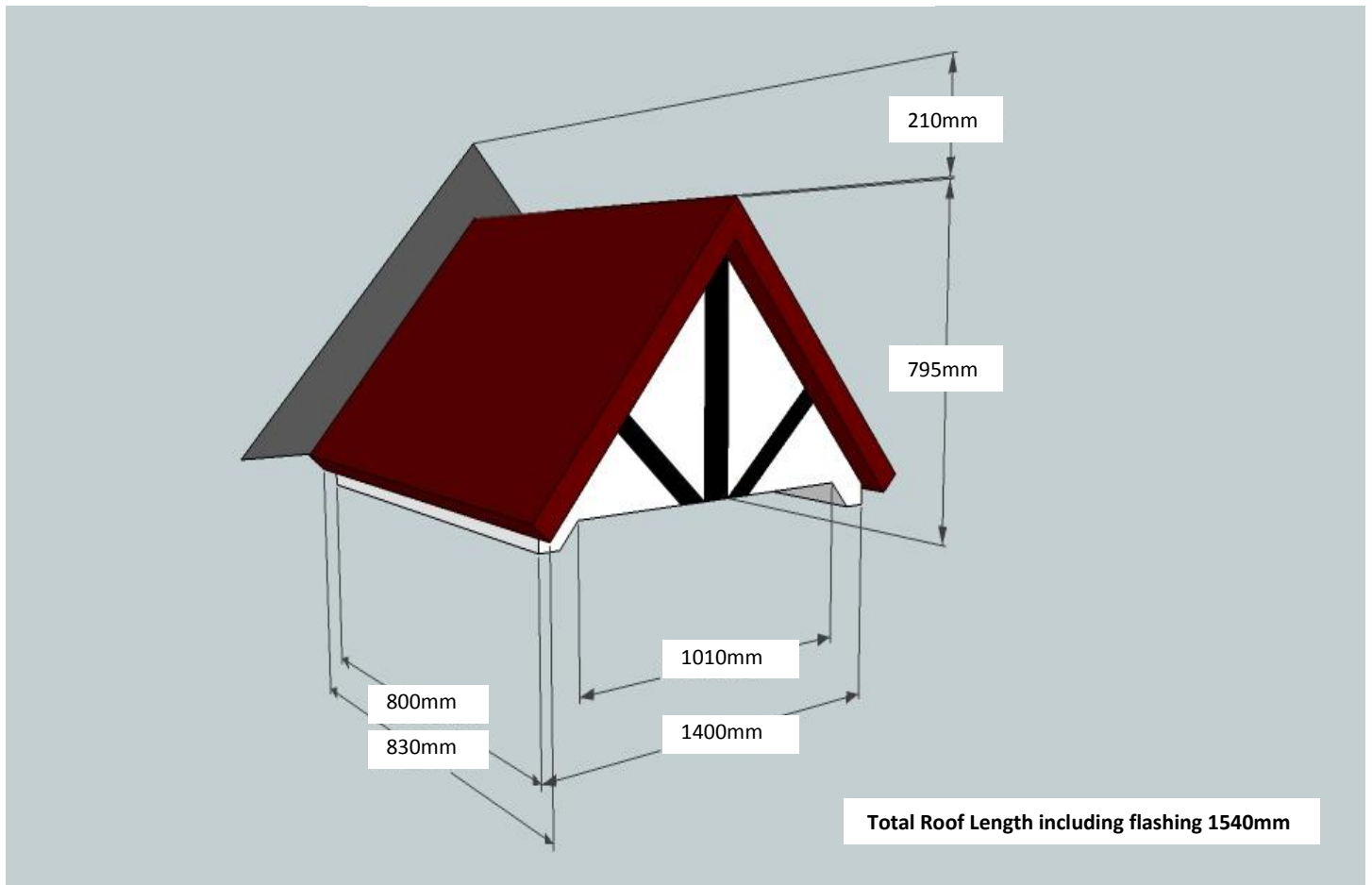

Fix the galvanised angle bracket (supplied) over the door using M8 Rawl Bolts (supplied), approximately 800mm over door casing. Lift and locate canopy on angle bracket. Level the canopy and fix using hammer fixings

Seal the flashing using clear silicone. Do not seal the soffit to the wall

CLEANING/AFTER CARE

All our canopies are maintenance free, they will never require painting. However, to maintain their good looks, periodic cleaning is advisable. Use warm water and detergent removing any persistent stains with a bristle brush. Clean off any tar or grease deposits with White spirit.

Duchess Door Canopy

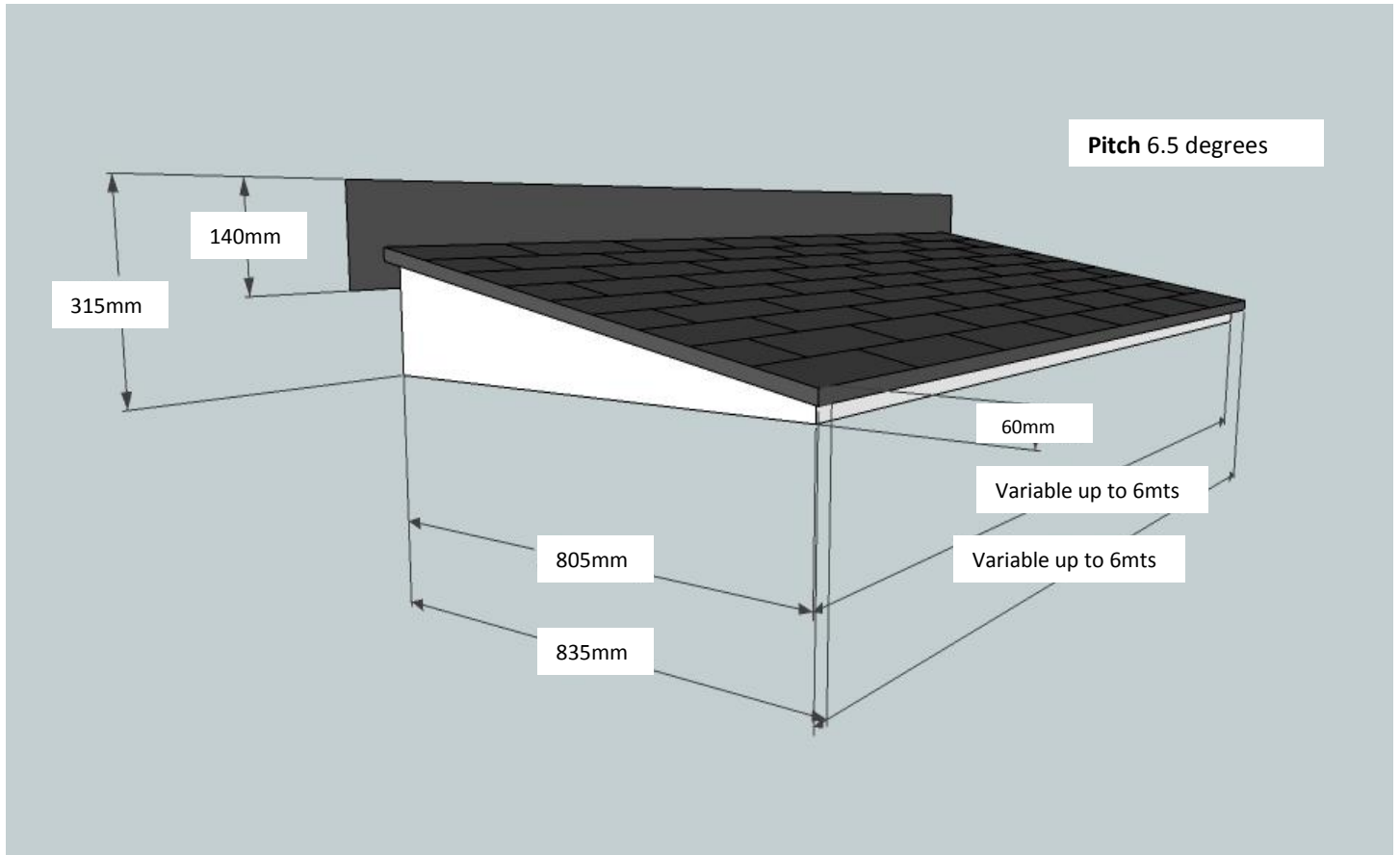

'L' shaped (galvanised) fixing brackets are supplied with canopies to aid installation.

Align the canopy (if using fixing brackets fix with M8 x 10 Bolts then align with the down pipe inside the canopy). Fix the canopy through the top flashing with hammer fixings.

The Duchess does not have any pre-determined fixing points due to the lengths being variable. Fixings: 60mm x 8mm hammer fixings (approx. 16 per standard canopy size of 1670mm).

Fix down the sides and bottom flanges, seal flashing at the top and sides with silicone sealant, use clear for the top, white for the sides. Do not seal the soffit to the wall.

CLEANING/AFTER CARE

All our canopies are maintenance free, they will never require painting. However, to maintain their good looks, periodic cleaning is advisable. Use warm water and detergent removing any persistent stains with a bristle brush. Clean off any tar or grease deposits with White spirit.



Countess Door Canopy

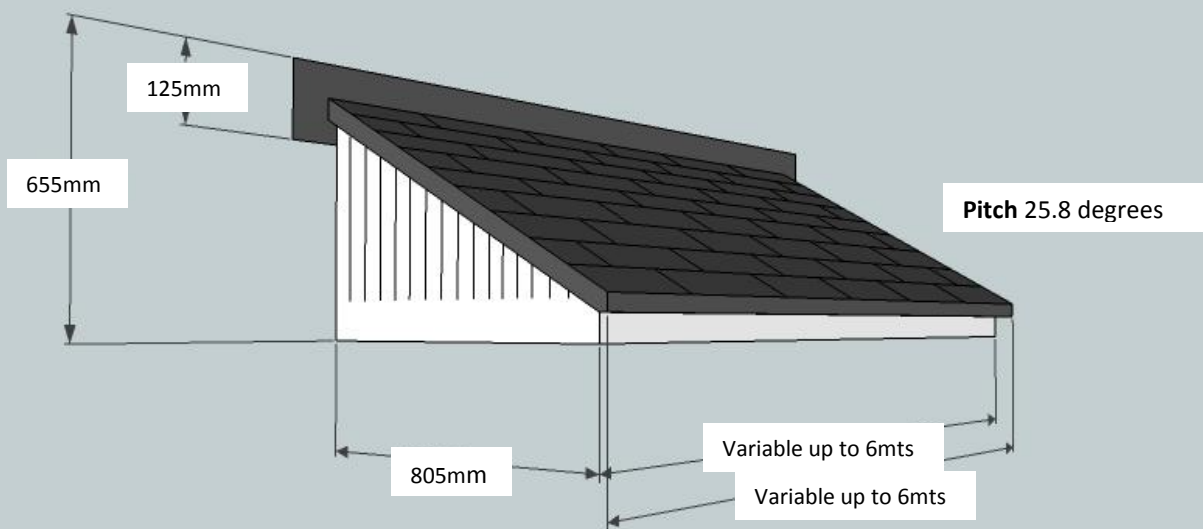

'L' shaped (galvanised) fixing brackets are supplied with canopies to aid installation.

Align the canopy (if using fixing brackets fix with M8 x 10 Bolts then align with the down pipe inside the canopy). Fix the canopy through the top flashing with hammer fixings.

The Countess does not have any pre-determined fixing points due to the lengths being variable. Fixings: 60mm x 8mm hammer fixings (approx. 16 per standard canopy size of 1670mm).

Fix down the sides and bottom flanges, seal flashing at the top and sides with silicone sealant, use clear for the top, white for the sides. Do not seal the soffit to the wall.

CLEANING/AFTER CARE

All our canopies are maintenance free, they will never require painting. However, to maintain their good looks, periodic cleaning is advisable. Use warm water and detergent removing any persistent stains with a bristle brush. Clean off any tar or grease deposits with White spirit.

Windsor Door Canopy

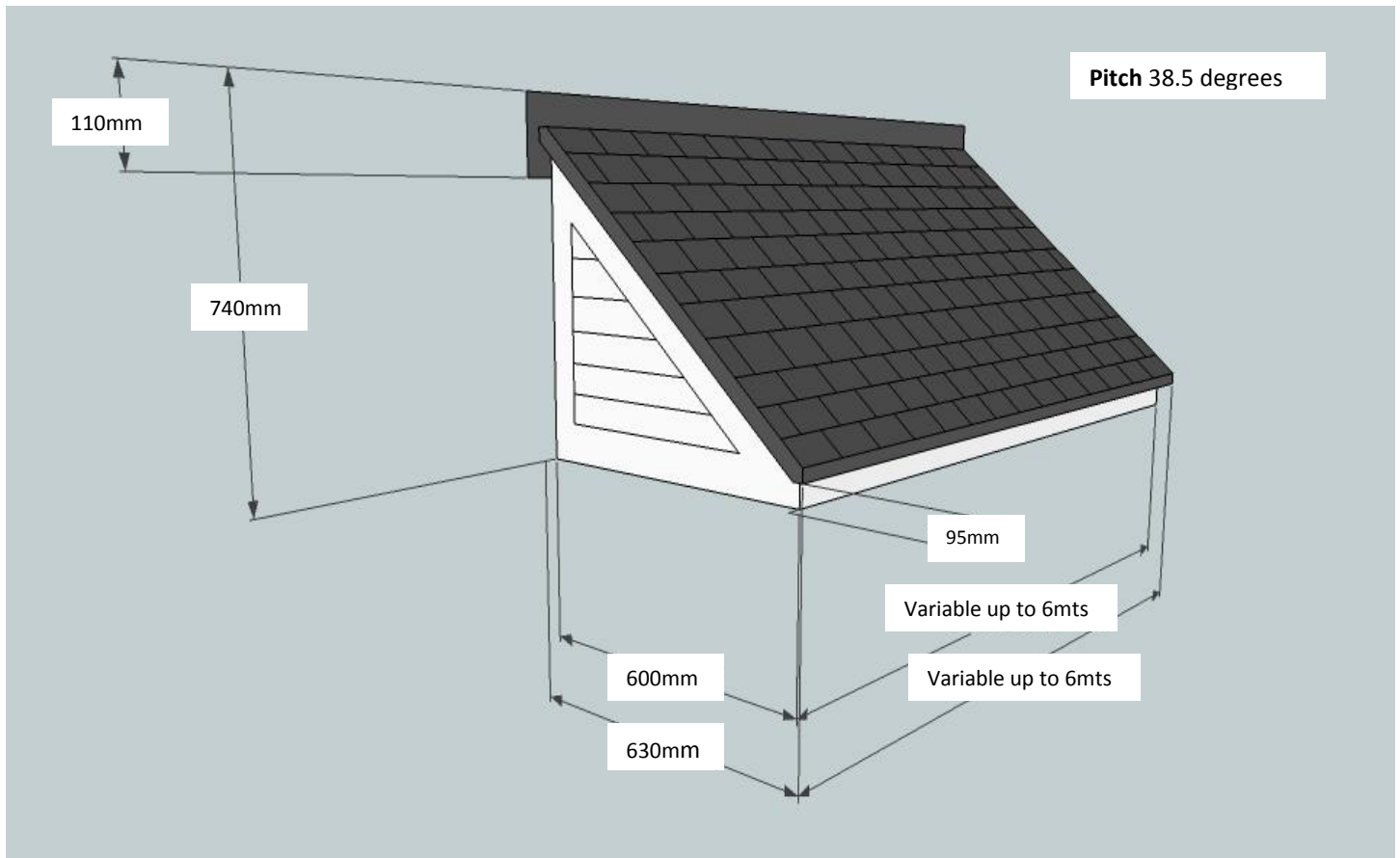

'L' shaped (galvanised) fixing brackets are supplied with canopies to aid installation.

Align the canopy (if using fixing brackets fix with M8 x 10 Bolts then align with the down pipe inside the canopy). Fix the canopy through the top flashing with hammer fixings.

The Windsor does not have any pre-determined fixing points due to the lengths being variable. Fixings: 60mm x 8mm hammer fixings (approx. 16 per standard canopy size of 1670mm).

Fix down the sides and bottom flanges, seal flashing at the top and sides with silicone sealant, use clear for the top, white for the sides. Do not seal the soffit to the wall.

CLEANING/AFTER CARE

All our canopies are maintenance free, they will never require painting. However, to maintain their good looks, periodic cleaning is advisable. Use warm water and detergent removing any persistent stains with a bristle brush. Clean off any tar or grease deposits with White spirit.

Clarendon Door Canopy

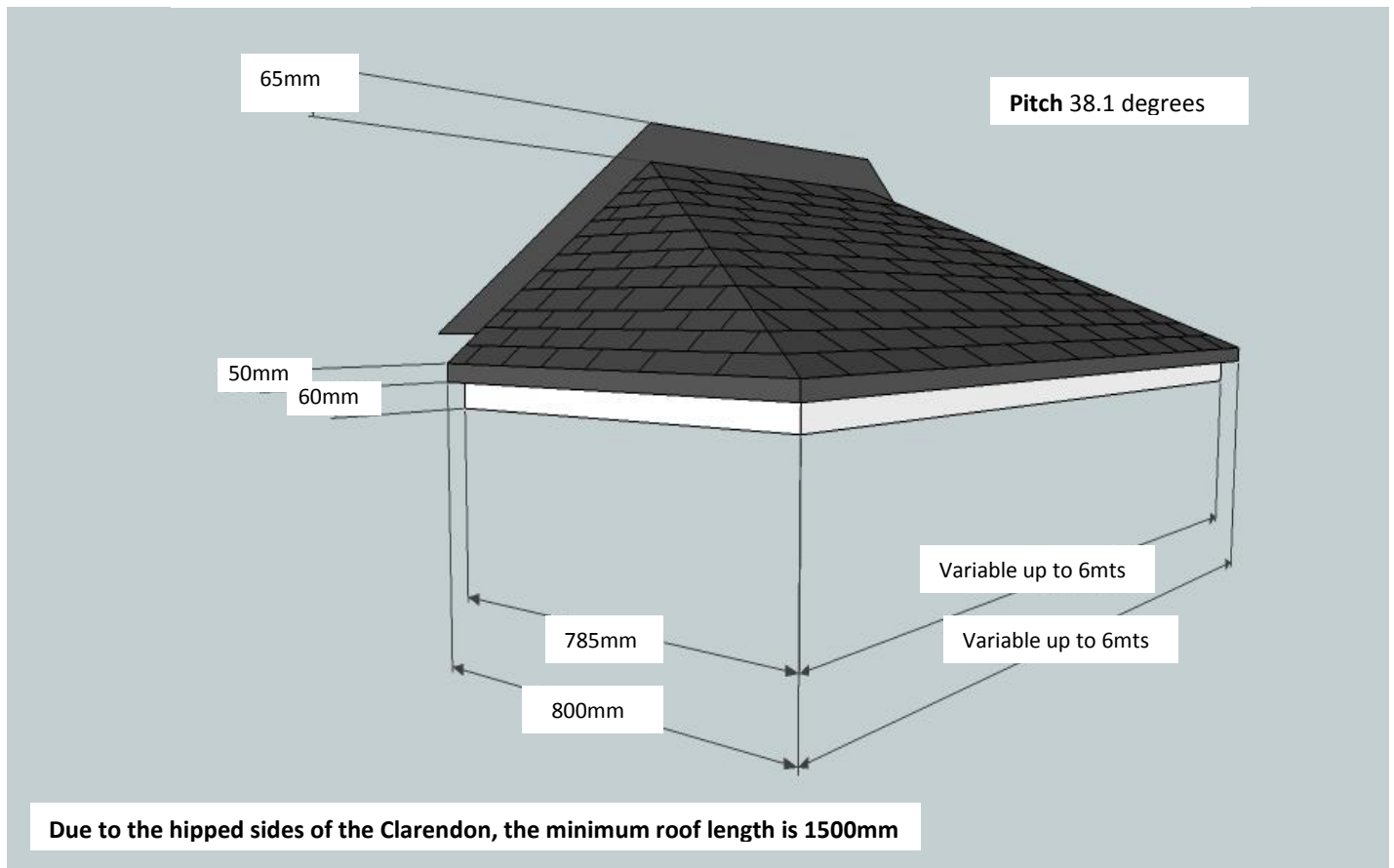

'V' shaped (galvanised) fixing brackets are supplied with canopies to aid installation.

Align the canopy (if using fixing brackets fix with M8 x 10 Bolts then align with the bracket slots). Fix the canopy through the top flashing with hammer fixings.

The Clarendon does not have any pre-determined fixing points due to the lengths being variable. Fixings: 60mm x 8mm hammer fixings (approx. 16 per standard canopy size of 1670mm).

Fix down the sides and bottom flanges, seal flashing at the top and sides with silicone sealant, use clear for the top, white for the sides. Do not seal the soffit to the wall.

CLEANING/AFTER CARE

All our canopies are maintenance free, they will never require painting. However, to maintain their good looks, periodic cleaning is advisable. Use warm water and detergent removing any persistent stains with a bristle brush. Clean off any tar or grease deposits with White spirit.

GRP Porch Roof

Height 130mm Length up to 2550 (internal frame) & projections up to 1275mm (internal frame)

Height 200mm Length up to 5750 (internal frame) & projections up to 1825mm (internal frame)

Available in white or brown with grey scalloped trim

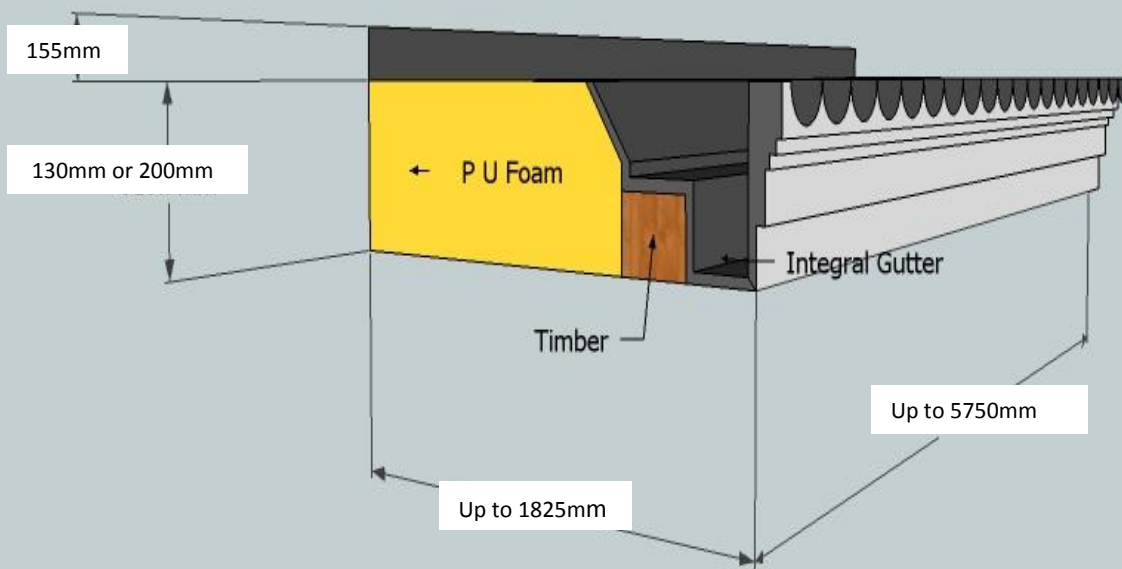

To size your porch roof, the integral guttering, fixed timber and front detail size are added to each internal frame dimension to obtain roof size.

130mm Porch: add 225mm to each internal frame dimension, ie: 450mm to length and 225mm to projection

200mm Porch: add 250mm to each internal frame dimension, ie: 500mm to length and 250mm to projection

CLEANING/AFTER CARE

All our canopies are maintenance free, they will never require painting. However, to maintain their good looks, periodic cleaning is advisable. Use warm water and detergent removing any persistent stains with a bristle brush. Clean off any tar or grease deposits with White spirit.

Bay Window Canopy

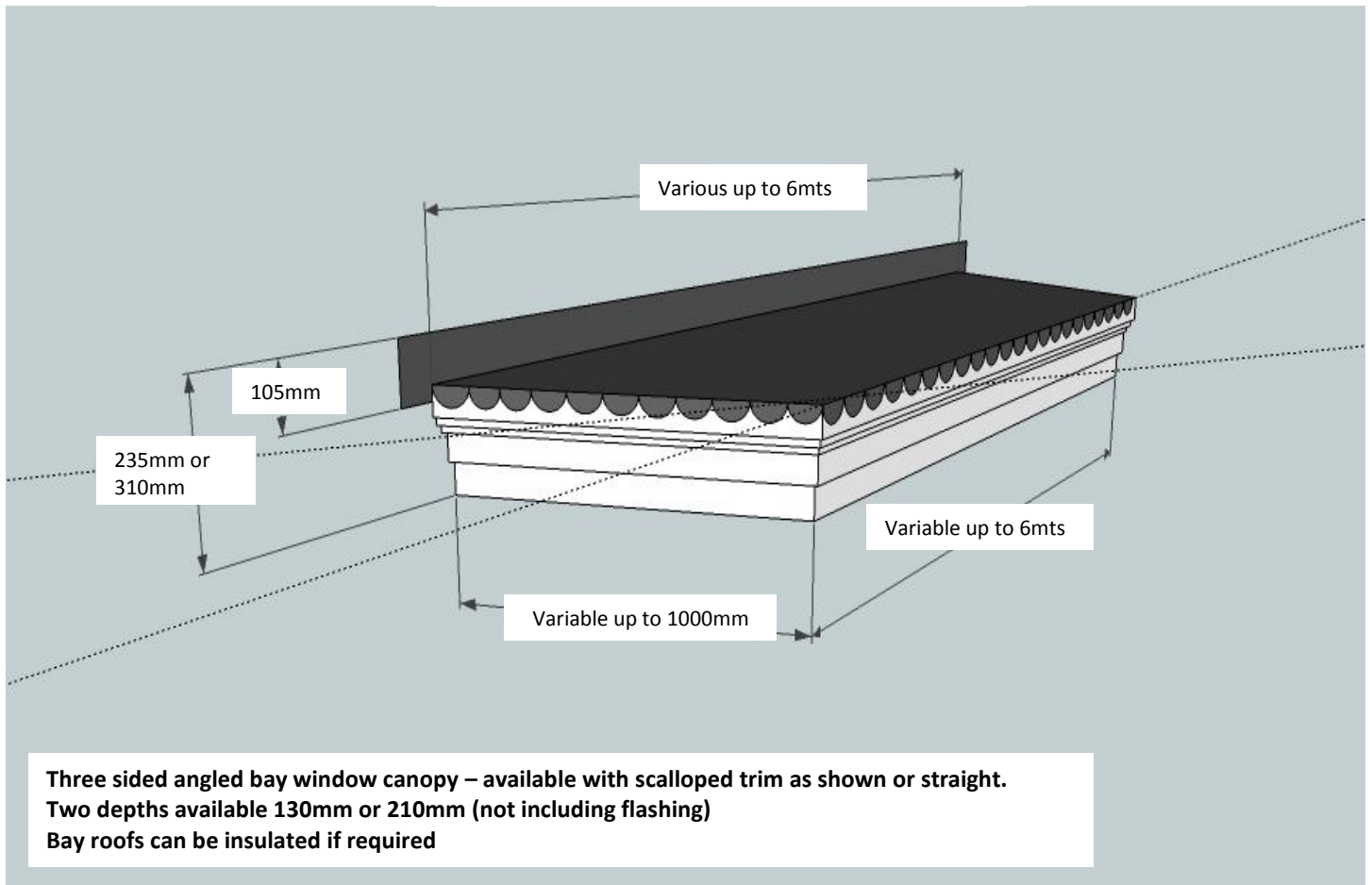

'L' shaped (galvanised) fixing brackets are supplied with canopies to aid installation.

Align the canopy (if using fixing brackets fix with M8 x 10 Bolts then align with the down pipe inside the canopy). Fix the canopy through the top flashing with hammer fixings.

Fix down the sides and bottom flanges, seal flashing at the top and sides with silicone sealant, use clear for the top, white for the sides.

CLEANING/AFTER CARE

All our canopies are maintenance free, they will never require painting. However, to maintain their good looks, periodic cleaning is advisable. Use warm water and detergent removing any persistent stains with a bristle brush. Clean off any tar or grease deposits with White spirit.



Georgian Décor Legs

Small

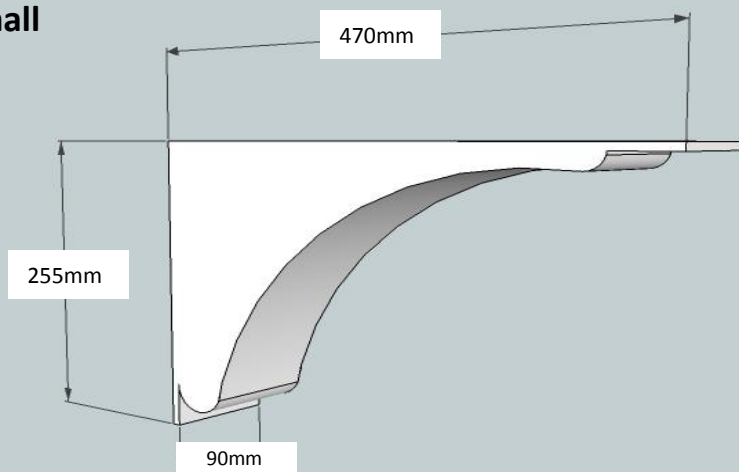

Available in white or brown

Large

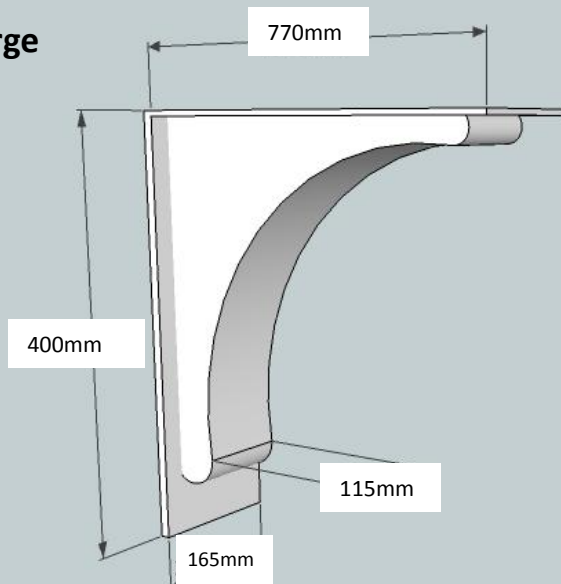

Decor legs available with flange or without

Large Décor Leg with flange 165mm
Large Décor Leg without flange 115mm

Small Décor Leg with flange 150mm
Small Décor Leg without flange 90mm

Gallows Bracket

Small

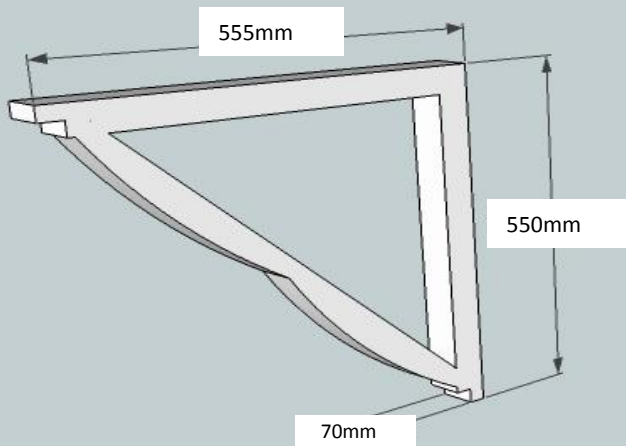

Available in white or brown

Large

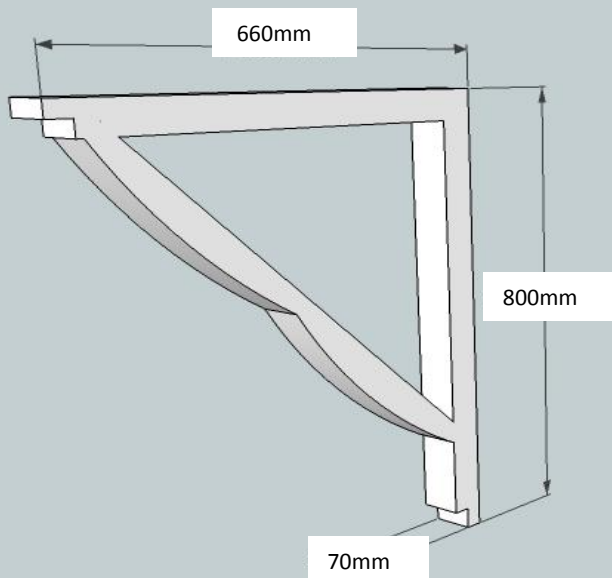



TRIM OPTIONS

All Canopies (except Royale) come with straight trim as standard.

Please specify if alternative trim is required



Decorative



Scalloped

Roof tile colours available



Brown



Terracotta

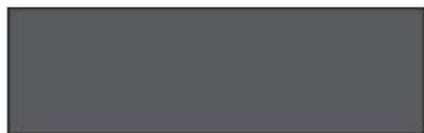

Slate

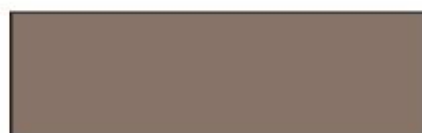

Earth

Soffit & accessory colours



White



Brown



Black